

PERMIT

CITY OF NAPOLEON - BUILDING DEPARTMENT
 255 West Riverview Avenue, Napoleon, Ohio 43545 - 419-592-4010

Permit No. 153-78 Issued 9/6/78
date

Job Location 80 Duquesne Drive
address

Lot 59 Riviera Heights 1st Add'n.,
sub-div or legal discript

Issued By R.E. Johnson
building official

Owner Beck Const. Co. 592-8307
name tel.

Address Rt. 3 Box 126 Napoleon, Ohio

Agent Self
builder-eng.-etc. tel.

Address _____

Description of Use Single family dwelling

Residential one
no. dwelling units

Commercial _____ Industrial _____

New XX Add'n. _____ Alter _____ Remodel _____

Mixed Occupancy _____

Change of Occupancy _____

Estimated Cost \$40,000.00

ZONING INFORMATION

district "A"	lot dimensions <u>83' x 120'</u>	area <u>9,960sq'</u>	front yd <u>25' OK</u>	side yds <u>11.5' ea. OK</u>	rear yd <u>68' OK</u>
max hgt <u>25' OK</u>	no pkg spaces <u>two OK</u>	no ldg spaces <u>n/a</u>	max cover <u>35% OK</u>	petition or appeal req'd <u>-----</u>	date appr <u>---</u>

WORK INFORMATION:

Size: Length 60' Width 28' 4" Stories Split-level Ground Floor Area 1532sq'

Height _____ Building Volume (for demo. permit) _____ cu. ft.

Electrical: 200 amp service & 20 circuits
brief description

Plumbing: Water & DWV Lines
brief description

Mechanical: Baseboard electric heat 9 zone
brief description

Sign: _____ Dimensions _____ Sign Area _____
type

Additional Information: CALL FOR INSPECTIONS MARKED ON ATTACHED SHEET: CERTIFICATE OF OCCUPANCY MUST BE ISSUED PRIOR TO BUILDING BEING OCCUPIED:

Date 9-8-78 Applicant Signature Frances M. Beck Sec'y & Treas.
owner-agent

	FEES	BASE	PLUS	TOTAL
<input checked="" type="checkbox"/>	BUILDING	\$ 69.00	0	\$ 69.00
<input checked="" type="checkbox"/>	ELECTRICAL	5.00	\$20.00	25.00
<input checked="" type="checkbox"/>	PLUMBING	3.00	8.00	11.00
<input checked="" type="checkbox"/>	MECHANICAL	0	0	0
<input type="checkbox"/>	DEMOLITION			
<input checked="" type="checkbox"/>	ZONING	0	0	0
<input type="checkbox"/>	SIGN			
	W78-20 WATER TAP	225.00	0	225.00
	S78-17 SEWER TAP	60.00	0	60.00
	E78-17 TEMP. ELECT.	10.00	0	10.00
	ADDITIONAL PLAN REVIEW	Struct. _____ hrs	Elect. _____ hrs	
	TOTAL FEES.....			\$400.00
	LESS MIN. FEES PAID _____ date _____			0
	BALANCE DUE.....			\$400.00 \$400.00

INSPECTION RECORD

	UNDERGROUND			ROUGH-IN						FINAL		
	Type	Date	By	Type	Date	By	Type	Date	By	Type	Date	
PLUMBING	Building Drains			Drainage, Waste & Vent Piping		REL	Indirect Waste			Drainage, Waste & Vent Piping	4-6-79 REL	
	Water Piping									Backflow Prevention		
	Building Sewer	4/16/79	REL	Water Piping		REL	Condensate Lines			Water Heater	" REL	
	Sewer Connection	"	"							FINAL APPROVAL	4/16/79 REL	
MECHANICAL	Refrigerant Piping			Refrigerant Piping			Chimney(s)			Grease Exhaust System		
				Duct Furnace(s)			Fire Dampers			Air Cond. Unit(s)		
	Ducts/Plenums			Ducts/Plenums			<input type="checkbox"/> Radiant Htr(s) <input type="checkbox"/> Unit Htr(s)			Refrigeration Equipment		
				Duct Insulation			Pool Heater			Furnace(s)		
			Combustion Products Vents			Ventilation <input type="checkbox"/> Supply <input type="checkbox"/> Exhst.				FINAL APPROVAL		
ELECTRICAL	Conduits & or Cable			Conduits/Cable			<input type="checkbox"/> Range <input type="checkbox"/> Dryer			Temp Service Temp Lighting		
	Grounding & or Bonding			Rough Wiring	3-1-79	NA	<input type="checkbox"/> Generator(s) <input type="checkbox"/> Motors			Fixtures Lampholders		
	Floor Ducts Raceways			Service Panel Switchboard			<input type="checkbox"/> Water Htr <input type="checkbox"/> Welder			Signs		
	Service Conduit			Busways Ducts			<input type="checkbox"/> Heaters <input type="checkbox"/> Heat Cable			Electric Mtr. Clearance		
	Temporary Power Pole			Subpanels			<input type="checkbox"/> Duct Htr(s) <input type="checkbox"/> Furnace(s)			FINAL APPROVAL	4-13-79 NA	
BUILDING	Location, Set-backs, Esmt(s)	9/11/78	REL	Exterior Wall Construction			Roof Covering Roof Drainage			Smoke Detector	4/16/79 REL	
	Excavation	"	"				Exterior Lath			Demolition (sewer cap)		
	Footings & Reinforcing	"	"				<input type="checkbox"/> Interior Lath <input type="checkbox"/> Wallboard					
	Floor Slab			Interior Wall Construction			Fire Wall(s)			Building or Structure	4/16/79 REL	
	Foundation Walls			Columns & Supports			Fireplace Chimney					
	Sub-soil Drain			Crawl Space <input type="checkbox"/> Vent <input type="checkbox"/> Access			Attic <input checked="" type="checkbox"/> Vent <input checked="" type="checkbox"/> Access	4/16/79	REL			
	Piles			Floor System(s)						FINAL APPROVAL BLDG. DEPT.		
			Roof System			Special Insp Reports Rec'd			Certificate of Occupancy Issued			
ADDITIONAL	INSPECTIONS, CORRECTIONS, ETC.						INSPECTIONS, CORRECTIONS, ETC.					
	CFC in Garage.						OK 4-21-79 NA					
	Reverse polarity reset laundry						OK 4-21-79 NA					
	Screw missing DR (11)											

CITY OF NAPOLEON
BUILDING INSPECTION DEPARTMENT
APPLICATION FOR CONSTRUCTION PERMIT
(PLEASE PRINT OR TYPE)

The undersigned hereby make application for the construction, installation, replacement or alteration as herein specified, agreeing to do all such work in strict accordance with the City of Napoleon's Building Code for 1, 2 and 3 Family Buildings.

Owner's Name Beck's Const Address RR3 Box 126
Builder's Name Beck's Const Phone RR3 Box 126 Tel. 592-8307

LOCAL INFORMATION (This information is required for building job.)

Location of Project Duquesne Drive Lot # 59
Subdivision Riverside Heights Lot Area 83 X 120 Sq. Ft.
Yard Setback: Front _____ Rear will send Left Side _____
Right Side _____ zoning District _____

BUILDING INFORMATION

Single Double _____ Attached _____ New Construction

Attic _____ Deck _____ Attached Garage

Detached Garage _____ Attached _____ Replacement _____

Brief Description of Work New split level home

Size: Length 60 Width 28'4 No. of Stories 3 Levels

Floor Area: 1st Floor 598 Sq. Ft. 2nd Floor 416 Sq. Ft.

3rd Floor 644 Sq. Ft. Basement _____ Sq. Ft.

Unfinished Area _____ yes _____ Garage 500

Foundation: Piers 30X30 Full Basement No Part Basement No

Concrete 8 Block 8X8X16 Size _____

Walls: Frame Brick _____ Block _____ Other _____

Specific Type of Siding Brick + Flu siding

APPLICATION FOR PERMIT SHALL BE ACCOMPANIED BY TWO COMPLETE SETS OF PLANS INCLUDING: ELEVATIONS, FLOOR PLANS, CROSS SECTIONS AND PLOT PLAN. IF ADDITIONS OR REVISIONS, SHOW ALL EXISTING STRUCTURE AND THEIR SIZE AND LOCATION. ALL PLANS SHALL BE DRAWN TO SCALE.

ESTIMATED COST OF COMPLETED PROJECT: _____

DATE 8/29/78 APPLICANT'S SIGNATURE Robert P Beck
OWNER-BUILDER-AGENT

CITY OF NAPOLEON
BUILDING INSPECTION DEPARTMENT
APPLICATION FOR ELECTRICAL PERMIT
(PLEASE PRINT OR TYPE)

The undersigned hereby makes application for the installation, replacement, or alteration of electrical equipment as herein specified, agreeing to do all such work in strict accordance with the City of Napoleon's adopted Electrical Code for 1, 2 and 3 Family Buildings.

Owner's Name _____ Address _____

Contractor's Name _____ Address _____ Tel. _____

LOT INFORMATION:

Location of Project _____ Zoning District _____

BUILDING INFORMATION:

Single Family _____ Double Family _____ Multiple Family _____

New Construction _____ Existing _____ Addition _____

Replacement _____ Remodel _____ Service Change _____

Size: Total Square Foot Per Floor _____ No. of Stories _____

DESCRIPTION OF WORK

Size of Service 200 AMP. Service Change Only No (Yes or No)

Total Number of New Circuits 20 Total Number of New Circuits Excluding Appliance Circuits 14

APPLIANCE CIRCUITS: (indicate quantity)

Electric Range 1 Range Hood 1 Clothes Dryer 1 Dishwasher 1

Air Conditioner 0 Attic Fan Blower 0 Room Exhaust Fan 2

Disposal 1 Hot Water Heater 1 Electric Oven 1

Require Temporary Electric yes (Yes or No)

Note: G.F.I.C. required for all temporary electric with approved ground rod at service.

APPLICATION FOR PERMIT SHALL BE ACCOMPANIED BY TWO COMPLETE SETS OF PLANS INCLUDING: ELECTRICAL LAY-OUT AND RISER DIAGRAM.

Estimated cost of completed project: _____

DATE 8/29/78 APPLICANT'S SIGNATURE _____

Robert L. Buel
OWNER-CONTRACTOR-AGENT

CITY OF NAPOLEON
 BUILDING INSPECTION DEPARTMENT
 APPLICATION FOR PLUMBING PERMIT
 (PLEASE PRINT OR TYPE)

The undersigned hereby makes application for the installation, replacement or alteration of plumbing system or device as herein specified, agreeing to do all such work in strict accordance with the City of Napoleon's adopted Plumbing Code for 1, 2 and 3 Family Buildings.

Owner's Name _____ Address _____

Contractor's Name _____ Address _____ Tel. _____

BUILDING INFORMATION:

Single Family _____ Double Family _____ Multiple Family _____ New Construction _____
 Addition _____ Remodel _____ Replacement _____ No. of Stories _____

DESCRIPTION OF WORK

Drainage Pipe Of: Cast Iron _____ Copper _____ Other Plastic

Size of Main Building Drain: 4" X Other _____

Size of Main Vent Stack: 3" _____ 4" X Other _____

Require Water Tap: yes (Yes or No) Require Sewer Tap: yes (Yes or No)

Size and Type of Water Tap 3/4" Plastic

Size and Type of Sewer Tap 4" Type of Joints Sealed Joints

No. of Water Closets-----	②	No. of Sump Pumps-----	1
No. of Bathtubs-----	①	No. of Lavatories-----	②
No. of Kitchen Sinks-----	①	No. of Automatic Washers-----	①
No. of Disposals-----	1	No. of Hot Water Heaters-----	1
No. of Dishwashers-----	1	No. of Shower Receptors-----	②
No. of Floor Drains-----	0	Other (Specify) _____	

Storm Drainage Outlet to: Storm Sewer yes Other _____

APPLICATION FOR PERMIT SHALL BE ACCOMPANIED BY TWO COMPLETE SETS OF A DRAINAGE ISOMETRIC, WITH ALL PIPES AND TRAPS PROPERLY SIZED. MUST INDICATE TOTAL DRAINAGE FIXTURE UNIT VALUE (dfu).

ESTIMATED COST OF COMPLETED PROJECT: _____

DATE 8/29/78 APPLICANT'S SIGNATURE Robert J. Beech
 OWNER-CONTRACTOR-AGENT

CITY OF NAPOLÉON
MECHANICAL PERMIT
(SINGLE FAMILY OR TYPE)

The undersigned hereby makes application for the installation, replacement or alteration of a heating system or device as herein specified, agreeing to do all such work in strict accordance with the City of Napoleon's adopted Mechanical Code for 1, 2 and 3 Family Buildings.

Owner's Name _____ Address _____

Contractor's Name _____ Address _____ Tel. _____

BUILDING INFORMATION:

Single Family _____ Double Family _____ Multiple _____ New Construction _____

Addition _____ Remodel _____ Replacement _____ No. of Stories _____

DESCRIPTION OF WORK

Heating System - Form Oil _____ Hot Water _____ Steam _____ Electric

Unit Heaters Oil Gas Heaters _____ Other _____

Type - Gravity _____ Forced _____ Radiant

No. of Thermostatical Heating Units 9

Hot Water - One Pipe _____ Two Pipe _____ Series Loop _____

Electric Heat - No. of Circuits 3 Other _____

Total Heat Loss of Area to be heated 16,000 Btu.

Rated Capacity of Furnace or Boiler _____ Btu.

No. of Furnaces _____ No. of Hot Air Runs _____

No. of Hot Water Radiators _____ Type of Fuel ELECT

Heating Units Located: Attic Space _____ Floor Level Suspended _____

Roof or Exposed to Outside Air _____ Attic _____ Other _____

APPLICATION FOR PERMIT SHALL BE ACCOMPANIED BY TWO COMPLETE SETS OF PLANS INCLUDING: LOCATION OF FURNACE OR UNIT HEATERS AND SIZE AND LOCATION OF FEEDER DUCTS AND RETURN AIR DUCTS. ALL PLANS SHALL BE DRAWN TO SCALE.

ESTIMATED COST OF COMPLETED PROJECT _____

DATE 8/29/78 APPLICANT'S SIGNATURE Robert J Beck
OWNER-CONTRACTOR-AGENT

CITY OF NAPOLEON

Engineering Department

ELECTRICAL INSPECTION FIELD REPORT

255 Riverview Avenue Napoleon, Ohio 43545

(Please Print or Type)

Date 4-13-79

Permit No. 153-78

Type of Inspection FINAL

Type of Occupancy RESIDENCE

I-FHM.
- CHECK RECEPT
LAUNDRY.

Project Name BECK CONST. CO.

Address 80 DUNDAS DR

City NAPOLEON State OHIO

Approved [checkmark]

Violation

Electrical Contractor BECK CONST.

Remarks:

Code Reference

NOTED HOUSE IS OCCUPIED.

1 #12 - NEUTRAL REVERSED ON WASHING
MACHINE RECEPTACLE.

4-21-79 - Sat 11:45 AM

OK on washing mach. Recept.

OK on GFCI garage Recept.

Screw still missing Recept. Plate Dining
Room.

Compliance Time

Inspectors Signature

Copies To: BECK CONST. CO.

NAPOLEON, OHIO

White - Applicant

Yellow - Engineering

Pink - Electrical Inspector

2 Bath
split head

3 Roof line

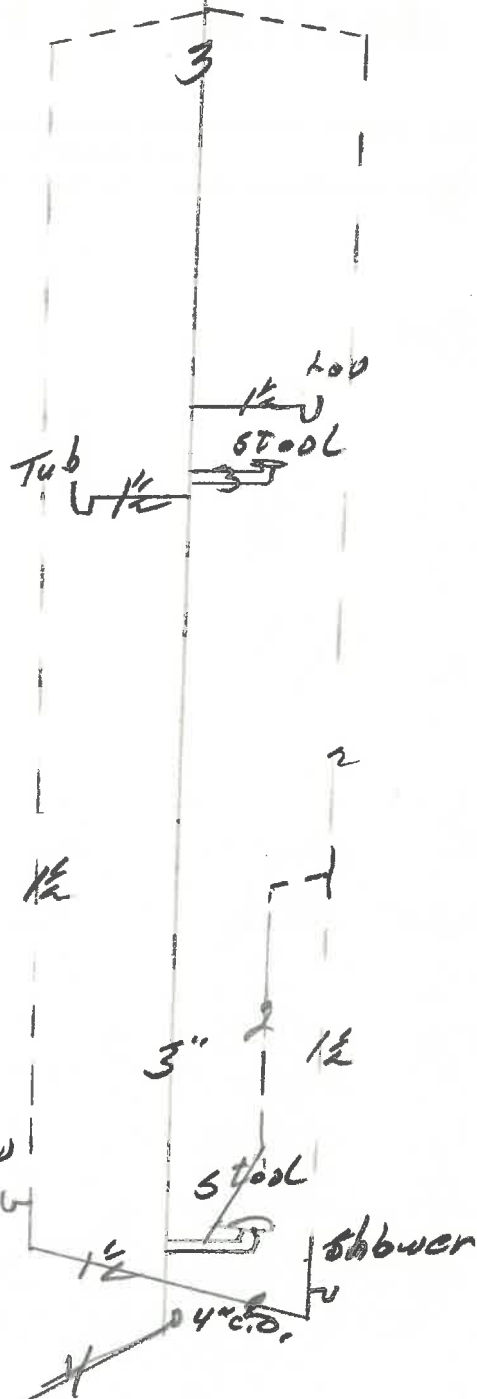

4' c.o.

Grade
line

PLUMBING

AIR CONDITIONING

HEATING

Residential

Meyers Heating & Plumbing, Inc.

Commercial

2611 N. SCOTT ST.

419-592-6771

NAPOLEON, OHIO 43545

APPLICATION FOR PERMIT TO TAP SEWER

(Print or Type)

Owner Beck Const. Co. NO. 578-17
Address Rt 3 Box 126 Napoleon, Ohio BLDG. PERMIT 153-78
Contractor Self PERMIT FEE \$ 60.00
Address _____ Tel. 592-8307 DATE PAID 9-8-78
for office use only

LOCATION OF CONNECTION

Street and No. 80 Duquesne Drive Sanitary XXX Storm _____
Lot No. 59 Subdivision Riviera Heights 1st Add'n. Size of Tap 4"
Size and Type of Sewer 4" Pre Joint ALL WORK MUST BE INSPECTED

I certify that the sewer will be used only as indicated and no other Drainage will be connected.
Date _____ Signature _____
owner-builder-agent
do not write below this line

INSPECTION RECORD

Date Inspected 9-18-78 Size and Type of Sewer 4" VIT. CLAY PRE-JOINT
Location FRONT OF HOUSE Depth 2' Type of Test 10' HEAD WATER
Inspected and Approved By: Ron Sonnenberg Inspector Date 9-18-78
Additional Information _____

Send copy to: BECK'S CONST.

SKETCH OF INSTALLATION

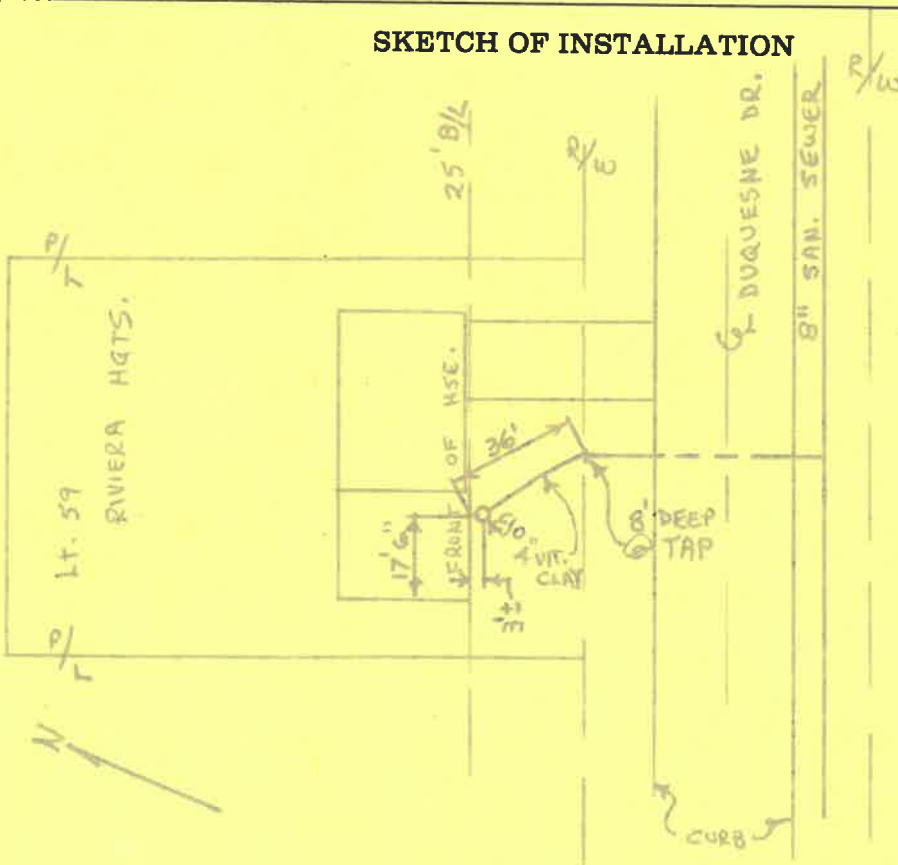

City of NAPOLEON, OHIO

255 RIVERVIEW AVENUE — (419) 592-4010



September 6, 1978

Mayor
Robert G. Heft

Mr. Robert L. Beck
Beck's Construction Co.
R. R. #3, Box 126
Napoleon, OH 43545

Clerk-Treasurer
Rupert W. Schweinhagen

Dear Bob:

Members of Council
Vern Holers, President

Building Permits for Lots 43, 54, 58 and 59 in Riviera Heights are being issued even though, in our opinion the plans do not provide adequate information to conform to the regulations of the Building Code. These permits are being issued because we know that you attempt to do the work correctly and abide by the regulations of the Code.

Lawrence Haase
James Jackson
Marilyn Rausch
David Strobel
William Young

City Manager
Alan E. Tandy

This Department is charged with the responsibility to issue permits on construction work, that is found to be within the minimum regulations of the Building Code and Zoning Ordinance, and also to make and maintain records of all construction within the City. Therefore, we ask that in the future, you submit plans, plat plans and specifications of sufficient clarity to indicate the nature and extent of the work proposed and show in detail that it will conform to the provisions of the Code.

Law Director
Keith Muehlfeld

We ask that future permit requests be accompanied by plans indicating foundation and beam detail, joist size and direction and crawl space venting. The floor plans and elevation drawings should be provided with information regarding window and door sizes, ceiling joist size and direction and window and door header sizes.

In our opinion, it is unnecessary to submit plumbing isometric drawings and electric service detail on residential plans. We would, however, appreciate having the floor plan indicate the number and location of all plumbing fixtures, heating and cooling equipment. Please continue to show the electric outlet switch and lighting schedule, however, please also include a proposed location for the main electric disconnect and distribution panel.

Including the above information, along with the information noted on the residential plan correction sheet, enclosed with your permits, will assist us in checking the plans and providing you with prompt service when Building Permits are requested.

We are attempting to establish a highly efficient and meaningful Building Inspection Program, and in order to accomplish this, we need the cooperation of all builders. With the cooperation of major builders, such as yourself, we can in good conscience expect proper and complete information and acceptable quality workmanship from all contractors working within the City.

If you have any questions, regarding our Inspection Program, or have any suggestions on how we can make improvements, please feel free to call.

Sincerely,

Robert E. Johnson
Dept. of Building & Zoning

REJ:dd

RESIDENTIAL PLAN CORRECTION SHEET

CITY OF NAPOLEON, Building Dept.
 255 West Riverview Avenue
 Napoleon, Ohio 43545
 (419) 592-4010

ADDENDUM to Permit No. 153-78
 Owner BECK
 Location Lt 59 RIVIERA HGT'S
80 DUQUESNE DR.

Please note the Items checked below and incorporate them into your plans as indicated: Permit not yet issued
 Correct Plans and Re-Submit. Permit issued Incorporate the items during construction.

GENERAL		
<input checked="" type="checkbox"/>	Provide 1 approved smoke detector.	Show size of members supporting porch roof.
<input checked="" type="checkbox"/>	Provide 1 hour fire wall and/or ceiling between garage and dwelling.	Provide double top plate.
	Provide (Class B) 1 hour fire rated door from garage to dwelling.	Provide design data for pre-fab. wood truss/members.
	Submit fully dimensioned plot plan.	<input checked="" type="checkbox"/> Ceiling joists undersized in. <u>GARAGE</u>
	Provide 1-3'0" x 6'8" exit door.	Roof rafters undersized in.
	Provide min. 22" x 30" attic access.	PLUMBING AND MECHANICAL:
	Provide min. 18" x 24" crawl space access opening.	<input checked="" type="checkbox"/> Terminate all exhaust systems to outside air.
	LIGHT AND VENTILATION:	Insulate ducts in unheated areas.
<input checked="" type="checkbox"/>	Provide mechanical exhaust or window in bathroom. <u>IN LOWER LEVEL</u>	Provide back flow device on all hose bibs.
	Provide Min. _____ sq. in. net free area attic ventilation.	ELECTRICAL:
	Provide min. _____ sq. in. net free area crawl space ventilation.	Show location of service entrance and service equipment panel.
	FOUNDATION:	<input checked="" type="checkbox"/> G.F.C.I. req'd. on Temp. Electric.
	Min. depth of foundation below finished grade 30".	<input checked="" type="checkbox"/> Outdoor and bathroom receptacles shall be protected by G.F.C.I. <u>GARAGE</u>
<input checked="" type="checkbox"/>	Min. size of footer. <u>8" x 16"</u>	METAL VENEERS:
	Provide anchor bolts 1/2" @ 8' o.c. 1' from each corner. Embedded 8" concrete and 15" in masonry.	Contact City Utilities Dept. to remove conductors and/or meter.
	Show size of basement columns.	Provide 18" x 18" x 3/4" wood backer for meter base.
	FRAMING:	<input checked="" type="checkbox"/> Provide approved system of grounding and bonding.
<input checked="" type="checkbox"/>	Show size of wood girder in. <u>CRAWL SPACE</u>	MISCELLANEOUS:
	Provide design data for structural member in	<input checked="" type="checkbox"/> Provide backwater valve in sub-soil drain tile.
	Floor joists under sized in.	<input checked="" type="checkbox"/> Provide approved sheathing and flashing behind masonry veneer.
<input checked="" type="checkbox"/>	Provide double joists under parallel partitions.	<input checked="" type="checkbox"/> Provide 15# felt underlayment on roof.
<input checked="" type="checkbox"/>	Provide 1" x 4" let in corner bracing or approved sheathing.	Provide adequate fireplace hearth extensions
<input checked="" type="checkbox"/>	Show size of headers for openings over 4' wide.	Install factory built fireplaces/stoves according to manufacturers recommendations.
		Terminate chimney 3' above roof or 2' above highest point of building within 10' of chimney.

ADDITIONAL CORRECTIONS: PROVIDE INFORMATION ON PEIRS IN CRAWL SPACE.

The approval of plans and specifications does not permit the violation of any section of the Building Code, or other City Ordinance or State Law. This addendum is attached to Permit No. 153-78 and made a part thereof.

Date Approved or Disapproved 9-6-78

Checked By RSJ Plan Examiner

Date Rechecked and Approved _____

Checked By _____

No. 184

CERTIFICATE OF OCCUPANCY
THE CITY OF NAPOLEON

ENGINEERING DEPARTMENT
DIVISION OF INSPECTION

This is to certify that the Building or Land as herein described complies with all the building and health laws and ordinances and with the provisions of the Zoning Ordinance.

Location of Occupancy 80 Duguesne Dr. Occupancy Single Family Dwelling

Owner of Property Beck's Construction Address 11-622, Rd. M, Rt. #3

Issued to Beck's Construction Address 11-622, Rd. M, Rt. #3

Zoning "A" Residence District Bldg. Permit No. 153-78

Substantial qualifications of occupancy

This certificate is issued by the City Building Inspector, as provided by law, and is to certify that construction is completed substantially in conformity with the approved plans and permission is hereby granted to occupy such building in compliance with such legal use and occupancy as authorized under the provisions of the ordinances of the City of Napoleon.

Issued this 5th day of June 19 79

This is a valuable record for owner or lessee and should be so preserved. Signed *R.E. Johnson* City Building Inspector

